

- KEY**
- - - Site Boundary
  - Proposed gully. Refer to 500 series drawings.
  - Proposed drainage channel. Refer to 500 series drawings.
  - Plane and inlay existing carriageway. Refer to 700 series drawings.
  - Proposed Footway. Refer to 1100 series drawings.

- Notes**
1. All dimensions are in millimetres unless otherwise stated.
  2. For cross sections locations, cross sections, typical sections, long sections and setting out information refer to 100 series drawings.
  3. For site clearance refer to 200 series drawings.
  4. For drainage refer to 500 series drawings.
  5. For earthworks refer to 600 series drawings.
  6. For pavements refer to 700 series drawings.
  7. For footway and paving details refer to 1100 series drawings.
  8. For traffic signs and road markings refer to 1200 series drawings.
  9. For street lighting and electrical works refer to 1300 & 1400 series drawings.

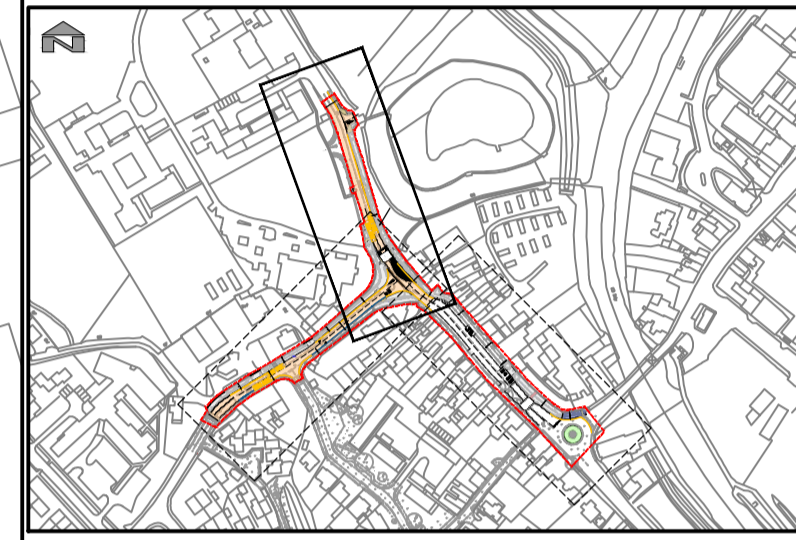

**SAFETY, HEALTH AND ENVIRONMENTAL INFORMATION**

IN ADDITION TO THE HAZARD/RISKS NORMALLY ASSOCIATED WITH THE TYPES OF WORK DETAILED ON THIS DRAWING, NOTE THE FOLLOWING

Note completed at this stage

IT IS ASSUMED THAT ALL WORKS WILL BE CARRIED OUT BY A COMPETENT CONTRACTOR WORKING WHERE APPROPRIATE TO AN APPROVED METHOD STATEMENT

© Hawfraint y Goron a hawliau cronfa ddata 2019 Arolwg Ordnans 100023415  
 © Crown copyright and database rights 2019 Ordnance Survey 100023415

Rev	Drawn	Chkd	Appd	Description	Date
P01	SL			First Issue	

Purpose of Issue

**S0 - Work In Progress**

Classification

**Confidential**

Client

**Monmouthshire County Council**

Project

**Williams Field Lane Active Travel Link**

Drawing

**General Arrangement Sheet 2 of 2**

Scale @ A1

1:250

Project No. **101496** Date **23-SEPT-2022**

Drawing No. **WFAT-WSP-01-XX-DR-C-0102** revision **P01.1**

